

X + 34 95 950

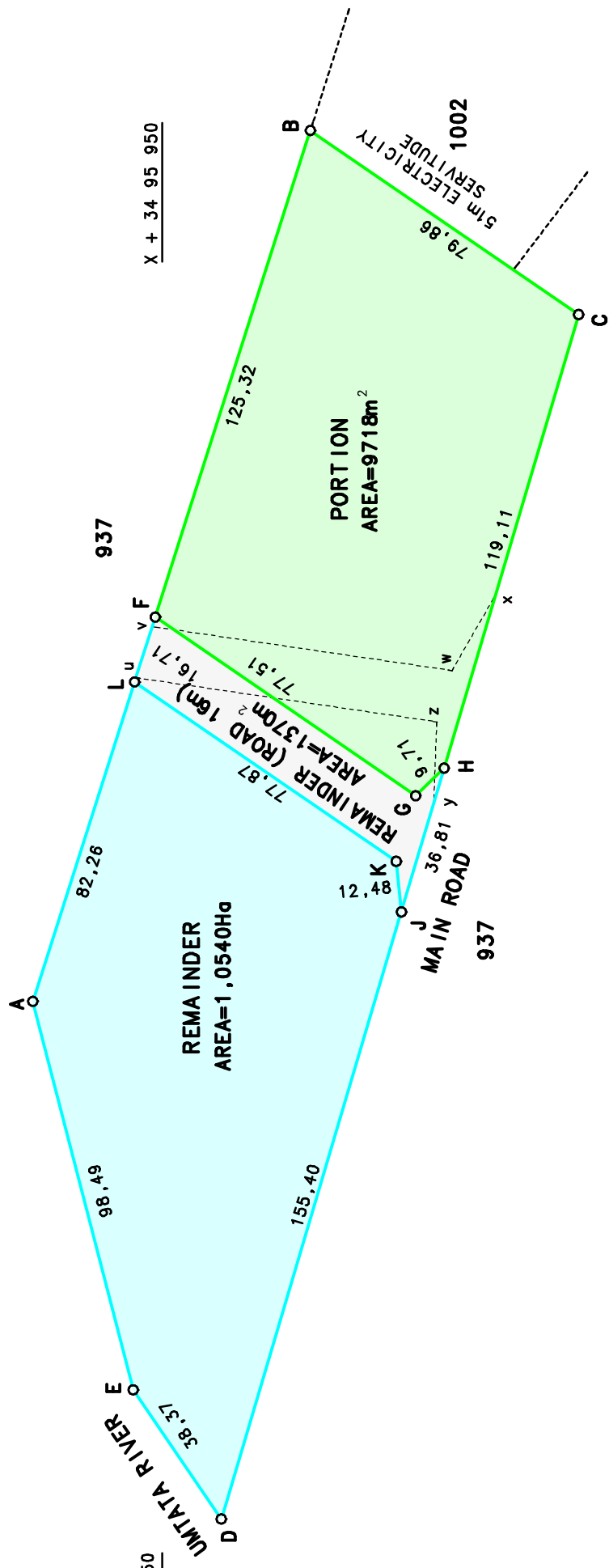

Y + 18 550

Y + 18 550

**NOTE:**

The figure lettered u v w x y z represents a Temporary Servitude Road Area over Erf 14530. Vide Diagram No. TR127/1994

**SEE ATTACHED**  
**LOCALITY SKETCH**

**CLIENT**  
**MR S VAN STAADEN**

**DRAWING TITLE**  
**PROPOSED SUBDIVISIONAL PLAN OF**  
**ERF 14530 UMTATA**  
SITUATE IN THE KING SABATA DALINDYEBO MUNICIPALITY  
AND ADMINISTRATIVE DISTRICT OF UMTATA  
**PROVINCE OF THE EASTERN CAPE**

**SCALE : 1/1500**  
**DATE : FEBRUARY 2010**  
**FILE : U431SP2**

**HAINES PALMER REABOW & ASSOCIATES**

PROFESSIONAL LAND SURVEYORS

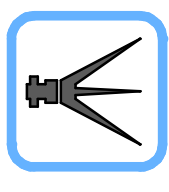

LAND SURVEYORS  
TOWNSHIP PLANNERS  
SECTIONAL TITLE SURVEYORS  
AERIAL SURVEY CONSULTANTS  
TOPOGRAPHICAL & ENGINEERING SURVEYORS

140 ALEXANDRA ROAD  
KING WILLIAM'S TOWN, 5601  
P.O. BOX 483  
KING WILLIAM'S TOWN, 5600  
EASTERN CAPE PROVINCE

TEL : 043 - 6424254 / 5  
FAX : 043 - 6424264  
E-MAIL : reabow@whurst.co.za